

CENTRAL HEATING AND SANITARY

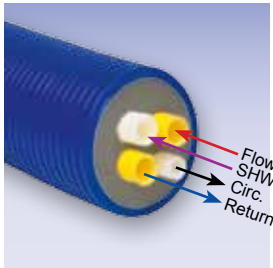

Quadro Heating Pipe

Flexible pre-insulated, self-compensating underground pipe comprising two heating pipes and two sanitary pipes. Designed for heating water (flow and return), and equipped with a sanitary hot water pipe and a pipe for the circulation loop.

Corrosion-resistant transport pipe in cross-linked PE-Xa in accordance with EN ISO 15875, with yellow oxygen diffusion barrier in accordance with DIN 4726 for the heating water pipes. Thermal, elastic, CFC-free foam insulation made from cross-linked PE-X with closed microcellular structure. Minimal water absorption capacity of < 1% in accordance with ISO 2896. Insulating PE centrepiece guarantees an effective separation of flow, return, hot water and circulation pipes. Corrugated outside casing in HDPE, made in accordance with the closed chamber principle to provide high-grade protection to the piping system.

Heating pipes

- Max operating pressure: 6 bar
- Max fluid temperature: + 95°C
- PE-Xa pipes: SDR 11

Sanitary pipes

- Max operating pressure: 10 bar
- Max fluid temperature: + 95°C
- PE-Xa pipes: SDR 7.4
- Standard full coil length: 100 m

Specific combinations?
Please contact us.

WRAS approval



PIPES

Art. No.	PE-Xa d _{out} /s	PE-Xa d _{in}	Outside casing d _{out}	Weight kg/m	Bending radius (1)
MQ16025C2520S	2 x 25/2.3	20	160	2.54	0.60
	1 x 25/3.5	20			
	1 x 20/2.8	15			
MQ16032C2520S	2 x 32/2.9	25	160	2.72	0.60
	1 x 25/3.5	20			
	1 x 20/2.8	15			
MQ16032C3225S	2 x 32/2.9	25	160	2.95	0.60
	1 x 32/4.4	25			
	1 x 25/3.5	20			

(1) Applicable practical values without risk of pipe distortion or damage.

COUPLINGS

Microflex PE-X coupling	Thread
Art. No.	inch
MJ3413425/23 (*)	3/4" M
MJ3413425/35	3/4" M
MJ3413420/28	3/4" M
MJ3414432/29 (*)	1" M
MJ3413425/35	3/4" M
MJ3413420/28	3/4" M
MJ3414432/29 (*)	1" M
MJ3414432/44	1" M
MJ3413425/35	3/4" M

(*) Two couplings required.

ACCESSORIES

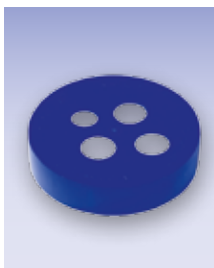

Fix points must be installed to absorb the possible effects of thermal expansion / shrinkage of the PE-Xa transport pipes.



Pipe	Dust cap MSQ	Rubber End cap EPDM	Fix point MFP	Thread
Art. No.	Art. No.	Art. No.	Art. No.	inch
MQ16025C2520S	MSQ160252520	MGQ1602532	MFP34 (*)	3/4" M
			MFP34	3/4" M
			MFP34	3/4" M
MQ16032C2520S	MSQ160322520	MGQ1602532	MFP44 (*)	1" M
			MFP34	3/4" M
			MFP34	3/4" M
MQ16032C3225S	MSQ160323225	MGQ1602532	MFP44 (*)	1" M
			MFP44	1" M
			MFP34	3/4" M

(*) Two fix points required.